

FEATURES

- LOW Cost, High Quality
- Compact Size, Light Weight
- High Performance
- Wide Operation Temperature Range
- Octave and Multi-octave Bands

APPLICATIONS

- Load isolation
- Module integration



SPECIFICATIONS@25°C:

Part Number	Frequency Range (GHz)	Band Width (MHz)	Insertion Loss (dB)	Isolation (dB.Max)	VSWR (Max)	Power Handling (W.Avg)	Operating Temperature	Connector Type	Size LxWxH(mm)	Case Type
WIS026039H003K	2.6-3.95	Full	0.3	20	1.25	3KW FWD	-15~+50	FDP32	280*76.2*180	WS43
WIS029031H002K	2.9-3.1	Full	/	20	1.2	2KW	-40~+80	WR284	160*110*170	TBD
WIS085096H300	8.5-9.5	Full	0.5	15	1.1	300	-15~+50	WR112	66.5*63.5*70	WS35
WIS090095H250	9-9.5	500	0.5	20	1.2	250	-40~+80	WR90	48.2*120*42	WS15/WS01
WIS106117H001K	10.6-11.7	Full	0.3	20	1.2	2KW	0~+50	WR75	Φ128*446	WS34
WIS116127H001K	11.6-12.7	Full	0.3	20	1.2	2KW	0~+50	WR75	Φ128*446	WS34
WIS135145H2K	13.5-14.5	1000	0.4	25	1.3	2KW	-40~+70	WR52	25*34*23	WM01/WS01
WIS139142H2K	13.95-14.25	300	0.3	25	1.15	2KW	-40~+80	WR62	52*33.3*33	WS16/WS01
WIS177212H100	17.7-21.2	Full	0.4	19	1.25	100	-20~+50	UG597/U	24*28+Φ60*90.5	WR32

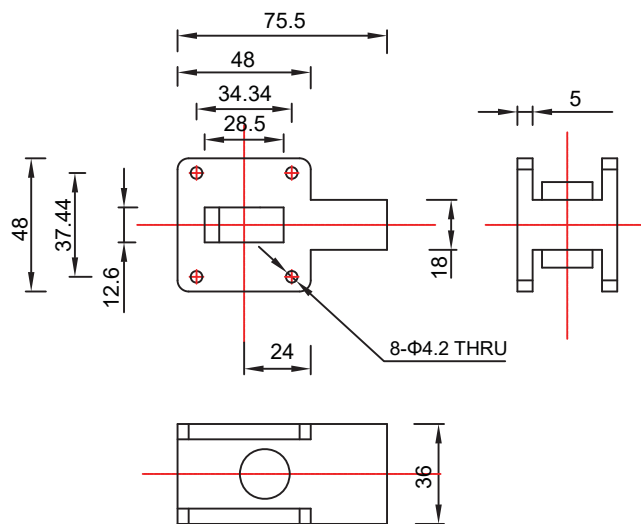

WS01

